



DRAINAGE_RESERVE

Harriet_Johnston_Drive

Hale_Court

NORTH_ISLAND_MAIN_TRUNK_RAILWAY

Hitchen_Road

10F

10E

NORTH_ISLAND_MAIN_TRUNK_RAILWAY

2 DP206719

1 DP321866

2 DP176205

STREET LIGHT DETAILS

TYPE A - 7.5m VICPOLE 125mm SQUARE SERIES COLUMN HOT DIPPED GALV, TWO PACT BLACK PAINT FINISH. CREE EDGE SQUARE SERIES XAL 1304C-UT LED LIGHT FIXTURE. 40 WATT LED (525MA DRIVER), TYPE 3M OPTICS

	mN	mE	
SL101	758725.10	421425.96	TYPE A
SL102	758691.62	421391.61	TYPE A
SL103	758654.97	421356.21	TYPE A
SL104	758625.10	421325.62	TYPE A
SL105	758648.98	421311.36	TYPE A
SL106	758690.71	421274.82	TYPE A
SL107	758743.52	421267.32	TYPE A
SL108	758709.46	421512.48	TYPE A

I, MICHAEL STEPHEN SMITH, CMENGNZ CPENG HEREBY BELIEVE ON ALL REASONABLE GROUNDS THAT THE LOCATIONS OF KERBS, CHANNELS, STREET LIGHTS AND FOOTPATHS ARE ACCURATELY PLOTTED IN RELATION TO BOUNDARIES AND IS CORRECT AS THIS INFORMATION HAS BEEN PROVIDED BY THE CONTRACTOR OF THE WORKS - KERRY DINES LTD.

MICHAEL STEPHEN SMITH DATE
CMENGNZ CPENG

NOTES

1. ALL COORDINATES ARE IN METRES AND IN TERMS OF GEODETIC 2000 MT. EDEN
2. ALL LEVELS ARE IN METRES AND IN TERMS OF THE LANDS AND SURVEY DATUM (MEAN SEA LEVEL) AUCKLAND 1946

LEGEND

- STD. KERB
- KERB & NIB
- MOUNTABLE KERB
- CHANNEL
- FOOTPATH
- CHIPSEAL ONLY
- EDGE OF SEAL
- TRANSITION TO EXISTING
- STREET LIGHTS
- DRIVEWAY

REV	ISSUED FOR 224C	RJP	3-21
A	ISSUED FOR 224C	RJP	3-21
	REVISION DETAILS	BY	DATE

PLOTTED:	DATE:	3-21
RJP	DATE:	3-21
APPROVED:	DATE:	3-21
MSS		

THIS DRAWING AND DESIGN REMAINS THE PROPERTY OF, AND MAY NOT BE REPRODUCED OR ALTERED, WITHOUT THE WRITTEN PERMISSION OF CIVILPLAN CONSULTANTS LIMITED. NO LIABILITY SHALL BE ACCEPTED FOR UNAUTHORISED USE OF THIS DRAWING.

CIVILPLAN
CONSULTANTS

Level 9, Laidlaw House, 20 Amersham Way, Manukau, Auckland. Phone: 09 222 2445

PROJECT TITLE:
DFH JOINT VENTURE
HITCHEN STAGES 10E,10F
POKENO

SHEET TITLE:
AS BUILT ROADING

ISSUE STATUS: **AS BUILT**

SCALE: (A1/A3) 1:500 / 1:1000

SCALE BAR 0 10 20 30 40 50m

DRAWING NUMBER: **136701-10-AB310** REV: **A**



DRAINAGE_RESERVE

Harriet_Johnston_Drive

Hale_Court

Hitchen_Road

NORTH_ISLAND_MAIN_TRUNK_RAILWAY

Clark_Rise

Leatham_Crescent

10F

10E

2 DP206719

1 DP321866

2 DP176205

- NOTES**
1. ALL COORDINATES ARE IN METRES AND IN TERMS OF GEODETIC 2000 MT. EDEN
 2. ALL LEVELS ARE IN METRES AND IN TERMS OF THE LANDS AND SURVEY DATUM (MEAN SEA LEVEL) AUCKLAND 1946
 3. ALL LOT CONNECTIONS ARE 100NB PVC UNLESS SHOWN OTHERWISE.
 4. MANHOLE INVERT LEVELS ARE LISTED CLOCKWISE FROM THE OUTLET PIPE.
 5. ALL MANHOLES ARE 1050NB WITH STANDARD DUTY LIDS AND COVERS UNLESS SHOWN OTHERWISE. ALL STORMWATER PIPES 225NB AND OVER ARE RCRRJ CLASS 2 UNLESS SHOWN OTHERWISE EXCEPT FOR CATCHPIT LEADS WHICH ARE ALL CLASS 4. ALL CATCHPIT LEADS ARE 225NB UNLESS SHOWN OTHERWISE.
 6. ALL CONCRETE PIPES AND STRUCTURES ARE MANUFACTURED BY HYNDS PIPES. ALL PLASTIC PIPES ARE MANUFACTURED BY MARLEY.

I, MICHAEL STEPHEN SMITH, CMENGNZ CPENG HEREBY BELIEVE ON ALL REASONABLE GROUNDS THAT THE PIPE SIZES, FITTINGS, POSITIONS, COORDINATES AND LEVELS SHOWN ARE ACCURATELY PLOTTED IN RELATION TO BOUNDARIES AND IS CORRECT AS THIS INFORMATION HAS BEEN PROVIDED BY THE CONTRACTOR OF THE WORKS - KERRY DINES LTD.

 MICHAEL STEPHEN SMITH DATE
 CMENGNZ, CPENG

LEGEND

	MANHOLE		EX.MANHOLE
	OUTLET		EX.CATCHPIT
	CATCHPIT		EX.SW LINE
	SW LINE		

REV	ISSUED FOR 224C	RJP	3-21
A	ISSUED FOR 224C	RJP	3-21
	REVISION DETAILS	BY	DATE

FLOTTED:	DATE:	3-21
RJP	DATE:	3-21
APPROVED:	DATE:	3-21
MSS		

THIS DRAWING AND DESIGN REMAINS THE PROPERTY OF, AND MAY NOT BE REPRODUCED OR ALTERED, WITHOUT THE WRITTEN PERMISSION OF CIVILPLAN CONSULTANTS LIMITED. NO LIABILITY SHALL BE ACCEPTED FOR UNAUTHORISED USE OF THIS DRAWING.

CIVILPLAN CONSULTANTS

Level 9, Laidlaw House, 20 Amersham Way, Manukau, Auckland. Phone: 09 222 2445

PROJECT TITLE:
 DFH JOINT VENTURE
 HITCHEN STAGES 10E,10F
 POKENO

SHEET TITLE:
 AS BUILT STORMWATER DRAINAGE

ISSUE STATUS: **AS BUILT**

SCALE: (A1/A3) 1:500 / 1:1000

SCALE BAR 0 10 20 30 40 50m

DRAWING NUMBER: **136701-10-AB410** REV: **A**

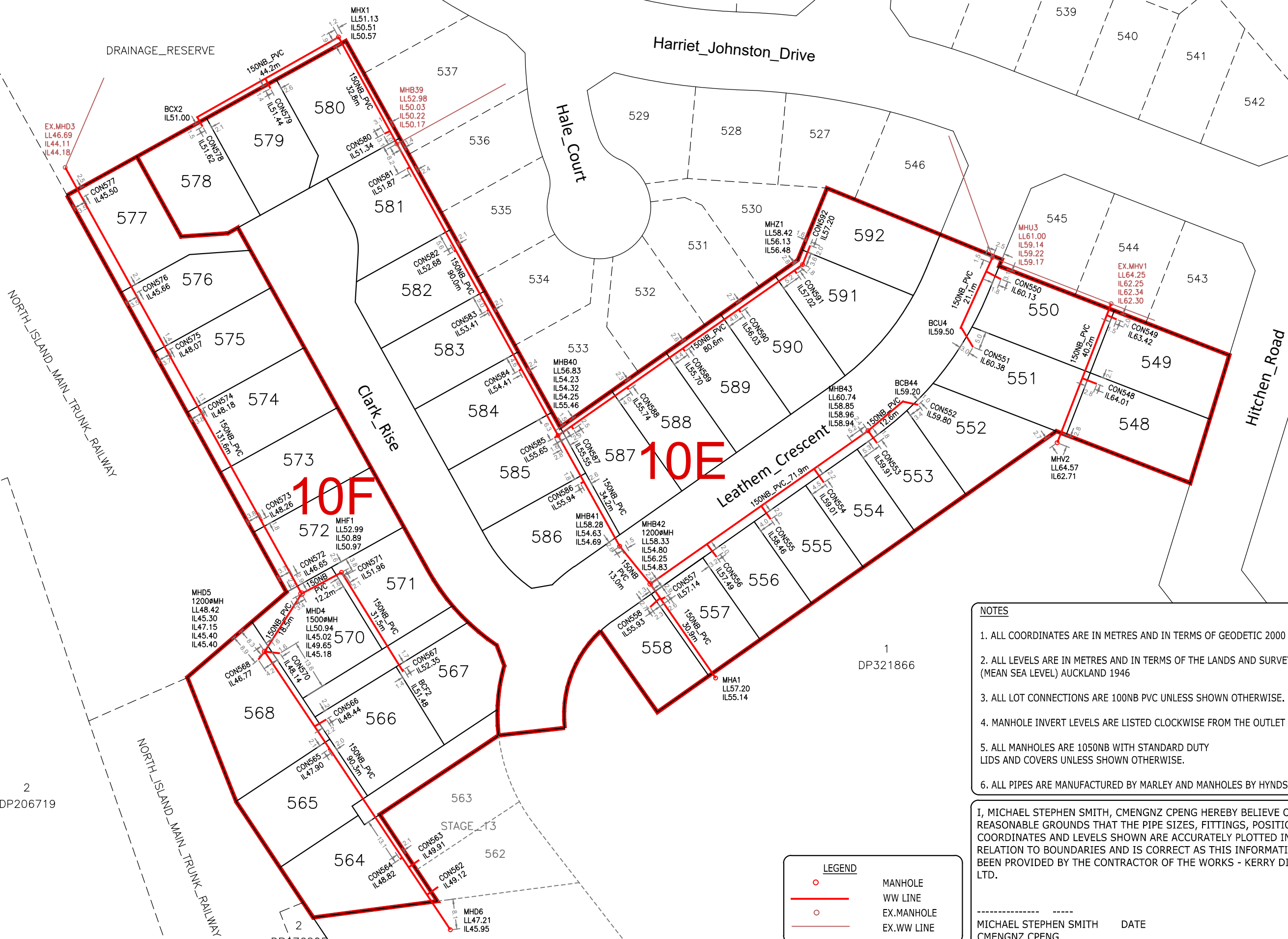

- NOTES**
1. ALL COORDINATES ARE IN METRES AND IN TERMS OF GEODETIC 2000 MT. EDEN
 2. ALL LEVELS ARE IN METRES AND IN TERMS OF THE LANDS AND SURVEY DATUM (MEAN SEA LEVEL) AUCKLAND 1946
 3. ALL LOT CONNECTIONS ARE 100NB PVC UNLESS SHOWN OTHERWISE.
 4. MANHOLE INVERT LEVELS ARE LISTED CLOCKWISE FROM THE OUTLET PIPE.
 5. ALL MANHOLES ARE 1050NB WITH STANDARD DUTY LIDS AND COVERS UNLESS SHOWN OTHERWISE.
 6. ALL PIPES ARE MANUFACTURED BY MARLEY AND MANHOLES BY HYNDS PIPES.

I, MICHAEL STEPHEN SMITH, CMENGNZ CPENG HEREBY BELIEVE ON ALL REASONABLE GROUNDS THAT THE PIPE SIZES, FITTINGS, POSITIONS, COORDINATES AND LEVELS SHOWN ARE ACCURATELY PLOTTED IN RELATION TO BOUNDARIES AND IS CORRECT AS THIS INFORMATION HAS BEEN PROVIDED BY THE CONTRACTOR OF THE WORKS - KERRY DINES LTD.

 MICHAEL STEPHEN SMITH DATE
 CMENGNZ CPENG

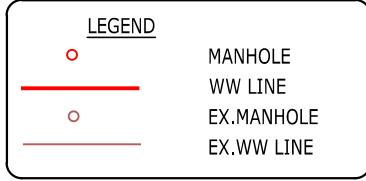

REV	ISSUED FOR 224C	RJP	3-21
A	ISSUED FOR 224C	RJP	3-21

PLOTTED:	DATE:	3-21
RJP	DATE:	3-21
DRAWN:	DATE:	3-21
RJP	DATE:	3-21
APPROVED:	DATE:	3-21
MSS	DATE:	3-21

CIVILPLAN CONSULTANTS

Level 9, Laidlaw House, 20 Amersham Way, Manukau, Auckland. Phone: 09 222 2445

PROJECT TITLE:
 DFH JOINT VENTURE
 HITCHEN STAGES 10E,10F
 POKENO

SHEET TITLE:
 AS BUILT WASTE WATER DRAINAGE

ISSUE STATUS: **AS BUILT**

SCALE: (A1/A3) 1:500 / 1:1000

SCALE BAR 0 10 20 30 40 50m

DRAWING NUMBER: **136701-10-AB411** REV: **A**

WASTEWATER COORDINATES

MH=MANHOLE, BC=BLANK CAP
CON=LOT CONNECTION

Table of wastewater coordinates with columns for ID, X, and Y. Includes entries like MHA1, MHB39, MHD3, etc.

STORMWATER COORDINATES

MH=MANHOLE, BC=BLANK CAP
CON=LOT CONNECTION

Table of stormwater coordinates with columns for ID, X, and Y. Includes entries like MH12.1, MH12.2, BC13.9, etc.

STORMWATER COORDINATES

MH=MANHOLE, BC=BLANK CAP
CON=LOT CONNECTION

Table of stormwater coordinates with columns for ID, X, and Y. Includes entries like CON548, CON549, CON550, etc.

WATER SUPPLY COORDINATES

FH=HYDRANT PV=PEET VALVE
SV=SLUICE VALVE WM=WATER METER

Table of water supply coordinates with columns for ID, X, and Y. Includes entries like FH204, SV206, WM548, etc.

Table titled 'Water Meter No. on Stage 10 E & F' listing lot numbers and corresponding water meter IDs.

Revision table with columns for REV, REVISION DETAILS, RJP, and DATE. Includes entry 'A ISSUED FOR 224C'.

Approval table with columns for FLOTTED, DATE, RJP, DATE, APPROVED, DATE, MSS, DATE. Includes dates like 3-21.

THIS DRAWING AND DESIGN REMAINS THE PROPERTY OF, AND MAY NOT BE REPRODUCED OR ALTERED, WITHOUT THE WRITTEN PERMISSION OF CIVILPLAN CONSULTANTS LIMITED. NO LIABILITY SHALL BE ACCEPTED FOR UNAUTHORISED USE OF THIS DRAWING.



PROJECT TITLE: DFH JOINT VENTURE HITCHEN STAGES 10E,10F POKENO

SHEET TITLE: AS BUILT COORDINATES

ISSUE STATUS: AS BUILT
SCALE: (A1/A3) NOT TO SCALE
DRAWING NUMBER: 136701-10-AB412 REV: A